

Sealed Gel Rechargeable Battery Product Specification

SLAUMXNPG17-12 (12V17AH)



Specifications

Nominal Voltage		12V
Rated capacity (20 hour rate)		17Ah
Dimensions	Total Height	167 mm (6.57 inches)
	Height	167 mm (6.57 inches)
	Length	181 mm (7.13 inches)
	Width	76 mm (2.99 inches)
Weight Approx		6.28 Kg (13.8 lbs)

Characteristics

Capacity 25°C(77°F)	20 hour rate(17.0A)	17.0 AH
	10 hour rate(16.0A)	16.0AH
	5 hour rate(2.89A)	14.5AH
	1 hour rate(9.35A)	9.07AH
	1.5 hour discharge to 10.5V	6.80 A
Internal Resistance	Full charged Battery at 25°C(77°F)	10 mΩ
Capacity affected by Temperature (20 hour rate)	40°C(104°F)	102%
	25°C(77°F)	100%
	0°C(32°F)	85%
	-15°C(5°F)	70%
Self-Discharge at 25°C(77°F)	Capacity after 1 month storage	92%
	Capacity after 3 month storage	90%
	Capacity after 6 month storage	80%
Terminal		F3 (M5 Bolts)
Charge (constant Voltage)	Cycle	Maximum Charging Current 5.10 A Voltage 13.80-14.40V
	Float	Voltage 13.50-13.80V

Outer dimensions (mm)

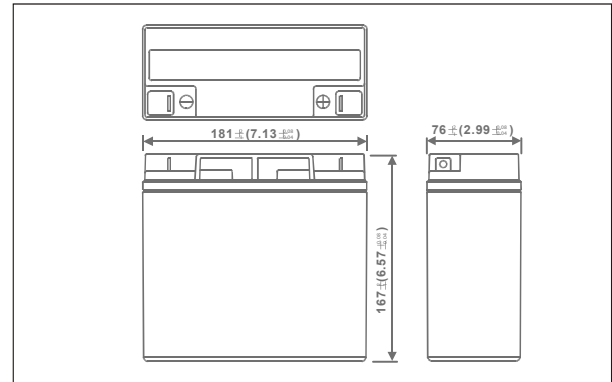

Terminal Type (mm)

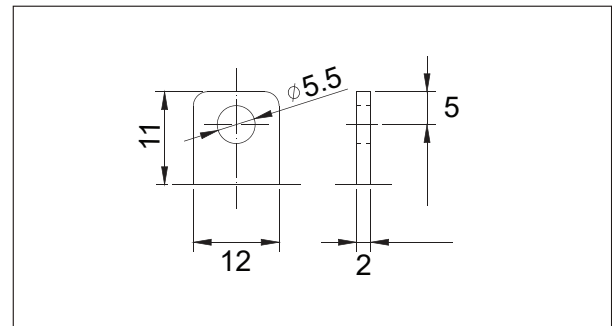

Discharge Curves 25 °C(77 °F)

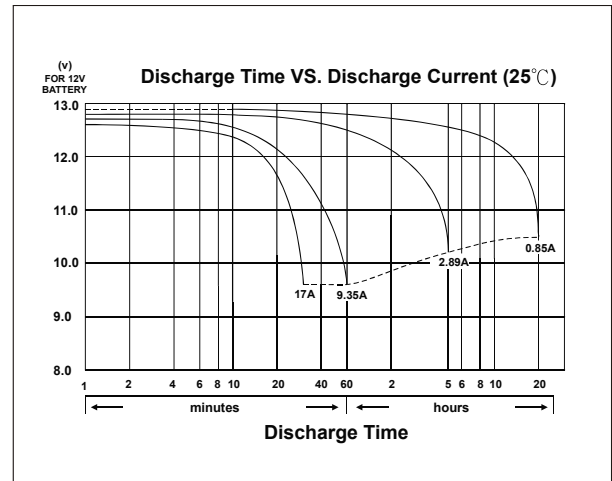

Constant Current(Amp) and Constant Power(Watt) Discharge Table at 25 °C(77 °F)

Time		5 Min	10 Min	15 Min	30 Min	1hr	2Hr	3Hr	4Hr	5Hr	10Hr	20Hr
9.60V	A	76.1	46.9	35.7	20.1	11.5	6.32	4.63	3.69	3.17	1.87	0.975
	W	771	521.4	420	222.6	133.2	76.2	56.22	44.82	38.46	22.92	11.94
10.20V	A	71.6	43.7	33.8	19	11	6.17	4.5	3.61	3.12	1.84	0.964
	W	738.6	501	406.8	215.4	129	73.8	54.84	43.68	37.62	22.44	11.64
10.50V	A	68.7	41.7	32.5	18.2	10.6	6.05	4.43	3.56	3.08	1.81	0.954
	W	700.8	476.4	391.2	206.4	124.8	71.4	53.64	42.78	37.02	22.08	11.46
10.80V	A	65.4	39.4	31	17.2	10.2	5.92	4.33	3.49	3.03	1.77	0.939
	W	637.8	436.2	366	192	120.6	70.2	52.32	41.7	36.36	21.54	11.16
11.10V	A	60.3	36.5	28.7	15.8	9.59	5.71	4.17	3.4	2.96	1.72	0.92
	W	543	381.6	328.2	179.4	114.6	66.6	50.28	39.96	34.98	20.88	10.8